



UNDERGROUND DRAINAGE & SEWERAGE PIPES

IS 15328



PRODUCT CATALOGUE

UNDERGROUND DRAINAGE & SEWERAGE PIPES

Finolex underground drainage and sewerage pipes are intended to carry soil and waste from buildings to sewers or drains and then to treatment plants or disposal points. Finolex underground drainage and sewerage pipes are recommended for buildings where hygiene is a prerequisite, such as hospitals, hotels, schools, building complexes, etc. Finolex sewerage pipes are specially designed for underground - non pressure applications such as gravity drainage, sewer flow and transportation of soil and waste discharge.

Finolex underground drainage and sewerage pipes are an ideal replacement for GI piping systems because they are lightweight, corrosion free and long lasting. These pipes are leak proof, which makes them free from ingress and seepage of water, thus ensuring hygiene.

Finolex brings its trademark quality and precision to its sewerage pipes assures superior strength and durability. Our stringent quality assurance approach across all stages of manufacturing gives the product a high degree of reliability, which makes Finolex underground drainage and sewerage pipes a preferred choice of leading MEP consultants, architects, builders, plumbing contractors, plumbers and quality conscious people across the country.

These pipes are available in sizes 110, 160, 200, 250, and 315 mm in stiffness classes of SN-2, SN-4 & SN-8 and conform to IS 15328. Sewerage pipes come with Selfit and Ringfit sockets in a standard length of 3 and 6 meters. Selfit pipes are self-socketed and can be joined with the help of solvent cement. Ringfit pipes need Lubricants for jointing. Sewerage Ringfit pipes are made with long lasting EPDM rubber rings. For ease of jointing and to ensure better insertion, the use of Finolex rubber lubricant is recommended.

DIMENSIONS OF SELFIT SEWERAGE PIPES:

Conforming to IS 15328

SN 2 (SDR 51, STIFFNESS CLASS 2 KN/m ²)						
Size (mm)	Size (inch)	Mean Outside Diameter (mm)		Wall Thickness (mm)		Std. Length (meter)
		Min	Max	Min	Max	
160	6"	160.0	160.5	3.2	3.7	3, 6
200	8"	200.0	200.6	3.9	4.5	3, 6

SN 4 (SDR 41, STIFFNESS CLASS 4 KN/m ²)						
Size (mm)	Size (inch)	Mean Outside Diameter (mm)		Wall Thickness (mm)		Std. Length (meter)
		Min	Max	Min	Max	
160	6"	160.0	160.5	4.0	4.6	3, 6
200	8"	200.0	200.6	4.9	5.6	3, 6



SN 8 (SDR 34, STIFFNESS CLASS 8 KN/m ²)						
Size (mm)	Size (inch)	Mean Outside Diameter (mm)		Wall Thickness (mm)		Std. Length (meter)
		Min	Max	Min	Max	
110	4"	110.0	110.4	3.2	3.7	3, 6
160	6"	160.0	160.5	4.7	5.4	3, 6
200	8"	200.0	200.6	5.9	6.7	3, 6

DIMENSIONS OF RINGFIT SEWERAGE PIPES:

Conforming to IS 15328

SN 2 (SDR 51, STIFFNESS CLASS 2 KN/m ²)						
Size (mm)	Size (inch)	Mean Outside Diameter (mm)		Wall Thickness (mm)		Std. Length (meter)
		Min	Max	Min	Max	
250	10"	250.0	250.8	4.9	5.6	6
315	12"	315.0	316.0	6.2	7.0	6

SN 4 (SDR 41, STIFFNESS CLASS 4 KN/m ²)						
Size (mm)	Size (inch)	Mean Outside Diameter (mm)		Wall Thickness (mm)		Std. Length (meter)
		Min	Max	Min	Max	
250	10"	250.0	250.8	6.2	7.0	6
315	12"	315.0	316.0	7.7	8.7	6



SN 8 (SDR 34, STIFFNESS CLASS 8 KN/m ²)						
Size (mm)	Size (inch)	Mean Outside Diameter (mm)		Wall Thickness (mm)		Std. Length (meter)
		Min	Max	Min	Max	
250	10"	250.0	250.8	7.3	8.3	6
315	12"	315.0	316.0	9.2	10.4	6

Batch number logic:

Year	Month	Day	Mc.No.	Shift
xxxx	xx	xx	xxx	x

For example, the batch number of pipes produced on Mc. no. 20 on 1st June 2021 in the 1st shift will be 202106010201

FINOLEX SOLVENT CEMENTS & LUBRICANT

SOLVENT CEMENT



PVC-U Solvent Cement for SWR (selfit) drainage and sewerage applications
As per IS : 14182

ml	100	250	500	1000
Container	Tin	Tin	Tin	Tin

LUBRICANT



Rubber lubricant is used for installation of Ringfit pipes and fittings

gms	50	100	250	500	1000
Container					Plastic Container

JOINTING

For Selfit Pipes

1. Measuring



2. Cutting

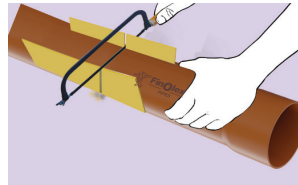

3. Chamfering



4. Cleaning



5. Solvent cement application

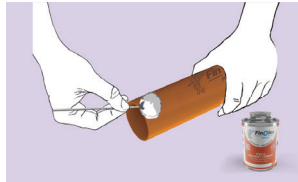
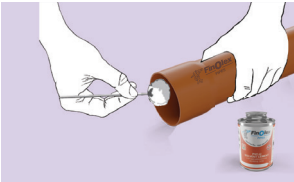

6. Assembly



For Ringfit Pipes

1. Cleaning



2. Rubber Ring fitment



3. Cutting

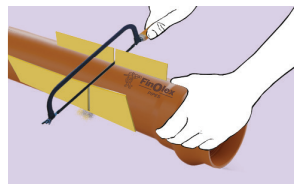

4. Chamfering & Cleaning



5. Lubricant application



6. Assembly



CERTIFICATION & APPROVALS

- Pipes are manufactured conforming to IS 15328 (Bureau of Indian Standards)
- Tested & approved by Central Institute of Plastics Engineering & Technology (CIPET)

FEATURES & BENEFITS

-  Sewerage pipes are non-reactive to most acids, alkalis, effluents, salt, minerals, etc
-  Sewerage pipes not subjected to galvanic or electrolytic action as PVC-U is a non-conductor of electricity
-  Self-socketed pipes, allow easy installation as compared to plain ended pipes
-  Smooth inner surface reduces frictional losses and scale formation
-  Corrosion free and rust-proof
-  Does not support fire and provides a good resistance to combustion
-  Low-maintenance and cost-effective
-  Excellent mechanical properties due to the use of special PVC-U compound
-  High degree of accuracy in manufacturing ensures dimensional control
-  Stringent quality control
-  Lightweight, easy to handle and transport

APPLICATIONS

-  Gravity drainage
-  Drainage of surface water (storm water)
-  Transportation and discharge of industrial effluents
-  Sewer flow for transportation of soil and waste discharge of domestic origin

Finolex Industries Limited

Registered Office:

Gat No. 399, Village Urse, Taluka Maval, District Pune - 410 506. Maharashtra, India.
Tel. No. : 02114 - 237251 | E-mail: investors@finolexind.com
CIN: L40108PN198PLC024153 | Website: www.finolexpipes.com

Corporate Office:

D1/10, MIDC, Chinchwad, Pune - 411 019. Maharashtra, India.
Tel. No. : 020 - 27408200
E-mail: care@finolexpipes.com

Follow us on:     

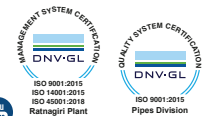

Disclaimer:

• Specifications are subject to change without prior notice. • The product images shown are for illustration purposes only and may not be an exact representation of the product. • The product images or other information cannot be construed as guarantee or suitability for a particular application. • Warranty applicable only for manufacturing defects when products are installed as per our standard guidelines and usage. • Warranty is not applicable if any other brand's products are used in combination with Finolex products. • In any case, the manufacturer/ seller's liability towards any claim is limited to replacement of, or credit for the defective product excluding any allied or incidental expenses. The manufacturing defect should be brought to notice within 24 months from manufacturing date.